

# IFLA 2018 STUDENT DESIGN CHARRETTE REPORT

**14 – 19 Jul 2018**

Venue:

**National University of Singapore**

Organised by:

**Singapore Institute of Landscape  
Architects**

Report prepared by:

Ms Heng Juit Lian IFLA 2018 Student Charrette  
Host Chair

**Stichting Nava Polman Gerson  
Foundation**

Awards Sponsor



**IFLA**  
INTERNATIONAL FEDERATION  
OF LANDSCAPE ARCHITECTS



Knowledge Partner

# FOREWORD

We would like to kindly express our gratitude to Dr. Hans Polman and the Nava Polman-Gerson Foundation for the generous and warm support for the IFLA 2018 Student Design Charrette for the awards and the time throughout the IFLA 2018 World Congress.

The IFLA Student Design Charrette was jointly curated with the National University of Singapore. The design theme was conceived in close relation to IFLA 2018 World Congress theme: Biophilic | Smart | Resilience. As such, three different design briefs and sites were introduced to simulate challenges faced by landscape architects in urbanized Asia.

# 2018 ORGANISING TEAM

**Curator.** Asst. Prof. Yun Hye Hwang (NUS)

**Host chair.** Juit Lian Heng

**Host Organising Committee.** Kenya Endo, Bronwyn Tan, Pearlyn Chang, Pham Le Anh

**Design Tutors.** Yuanqiu Feng (NUS and U.Michigan) + Agnieszka O. Guizzo (NUS),  
Melissa Yip (AECOM) + Liu Huei Lyn (PUB),

Kenya Endo (Ramboll Studio Dreiseitl) + Ryan Shubin (Ramboll Studio Dreiseitl)

**Knowledge Facilitators.** Shufen Yang (NParks), Chih Min Boo, Choon Hock Poh  
(CUGE, NParks)

**Students Assistants.** Helen Lei Fan, Ashley Sun, Yitong Wu

**35 Students from** Australia, China, Cameroon, Columbia, France, Indonesia, Malaysia,  
United Kingdom, United States of America, Japan, New Zealand, Hong Kong, South  
Korea, Thailand, Singapore

## STUDENT WINNERS

- 3 winning teams consisting of students in mixed groups from different nationalities and institutions.
- For diversity, students from different levels ranging from Diploma, Bachelor and Postgraduate studies were included.



# STUDENT PARTICIPANTS

## TEAM BIOPHILIC

### Group Biophilic 1 (B1)

1	Ahrum	Oh	Nanyang Academy of Fine Art	Singapore
2	Carmen	Yuen	University of Melbourne	Australia
3	Halimah	Azzahrah	Bogor Agricultural University	Indonesia
4	Seo Yong	Lee	Hankyoung University	South Korea

### Group Biophilic 2 (B2)

1	Anna	Noda	Kobe University	Japan
2	Ashley	Sun	NUS	Singapore
3	Gayle	Souter-Brown	Auckland University of Technology	New Zealand
4	Suyue	Huo	School of Architecture, South China University of Technology	China

### Group Biophilic 3 (B3)

1	Kwan Ki	Kwong	The University of Hong Kong	Hong Kong
2	Qiang	Zhu	Beijing Forestry University	China
3	Vanessa	Juan	Temasek Polytechnic	Singapore

## TEAM SMART

### Group Smart 1 (S1)

1	Chihiro	Okajima	Kogakuin University	Japan
2	Constanza	Jara	University of Melbourne	Australia
3	Kasarin	Naipongprasit	Chulalongkorn University	Thailand
4	Sheila	Lim	Temasek Polytechnic	Singapore

### Group Smart 2 (S2)

1	Kwok Cheong	Cheng	The University of Hong Kong	Hong Kong
2	Marian Johanna	Rugeles Pérez	Universidad Pontificia Bolivariana	Colombia
3	Taufik	Septiyan Maulana	Bogor Agricultural University	Indonesia
4	Yaw	Jing Kar	Nanyang Academy Of Fine Arts	Singapore

### Group Smart 3 (S3)

1	Dianne	Lê	Rutgers University	United States
2	Helen	Fan Lei	NUS	Singapore
3	Leonard	See	Ngee Ann Polytechnic	Singapore
4	Mardiana	Pulungan	Bogor Agricultural University	Indonesia

## TEAM RESILIENCE

### Group Resilience 1 (R1)

1	Lok Chi Audrey	Chan	University of Edinburgh	Hong Kong
2	Marina	Pizzotti	University of Melbourne	Australia
3	Muhamma d Nur Azrin	Abdul Kadir	Ngee Ann Polytechnic	Singapore
4	Napon	Jaturapuchapornpong	Chulalongkorn University	Thailand

### Group Resilience 2 (R2)

1	Iris	Olie	École Nationale Supérieure de Paysage - France	France
2	Ming Wei	Lim	Nanyang Academy of Fine Arts	Malaysia
3	Muhamma d Faisal	Ramadhan	Bogor Agricultural University	Indonesia
4	Yitong	Wu	NUS	Singapore

### Group Resilience 3 (R3)

1	Fritz Noel	Bayong Momha	Universitat Omar Bongo	Gabon
2	Hiroki	Kawazoe	Kobe University	Japan
3	Lim	Sherine	Universiti Teknologi Malaysia	Malaysia
4	Muhamma d	Hakim	Temasek Polytechnic	Singapore

# 1<sup>st</sup> Prize : Interweave in Punggol | when biodiversity and city are one

Theme: RESILIENCE

## Team members:

- Iris Olié, École Nationale Supérieure de Paysage, France
- Ming Wei Lim, Nanyang Academy of Fine Arts, Singapore
- Muhammad Faisal Ramadhan, Bogor Agricultural University, Indonesia
- Yitong Wu, National University of Singapore

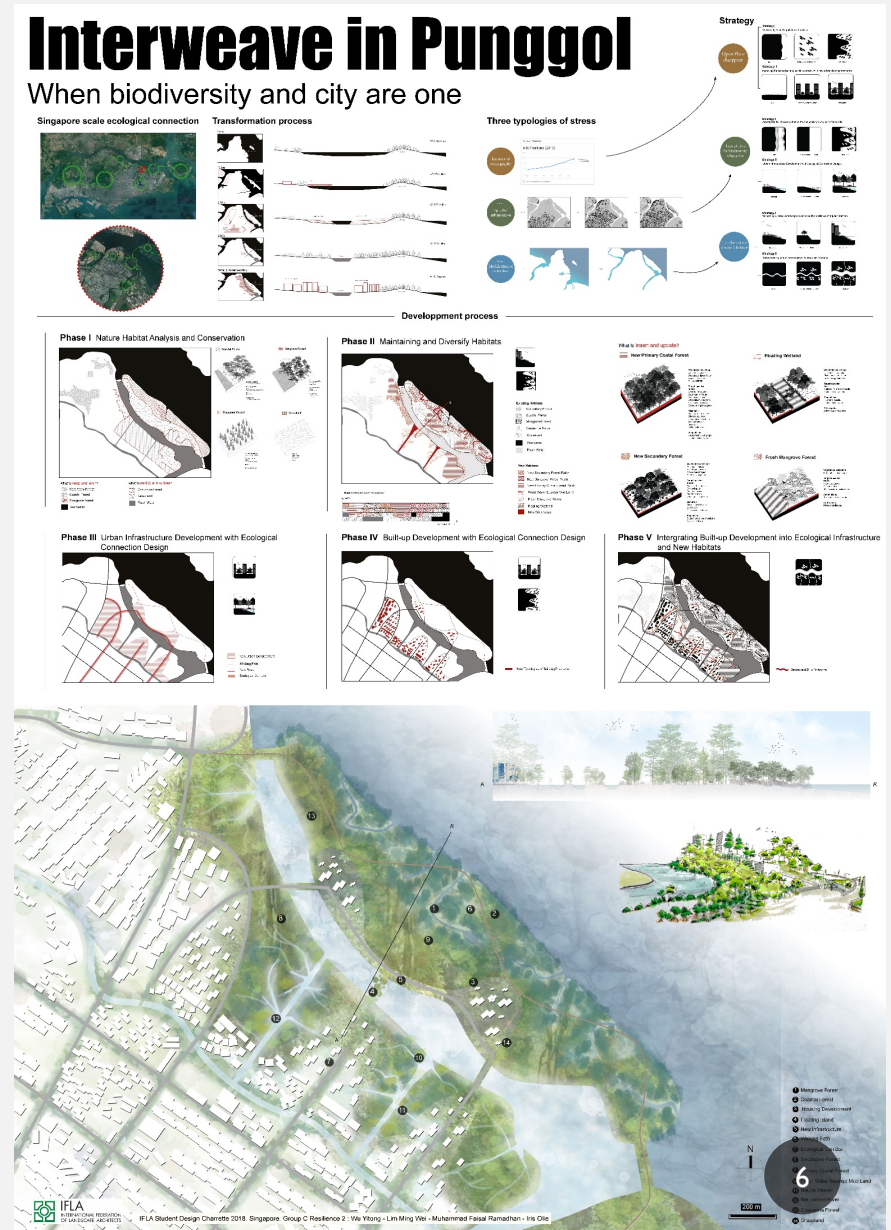



## 2<sup>nd</sup> Prize :

# Understanding Mangrove Dynamics through Living Museum

Theme: SMART

### Team members:

- Chihiro Okajima, Kogakuin University, Japan
- Constanza Jara, University of Melbourne, Australia
- Kasarin Naipongprasit, Chulalongkorn University, Thailand
- Sheila Lim, Temasek Polytechnic, Singapore

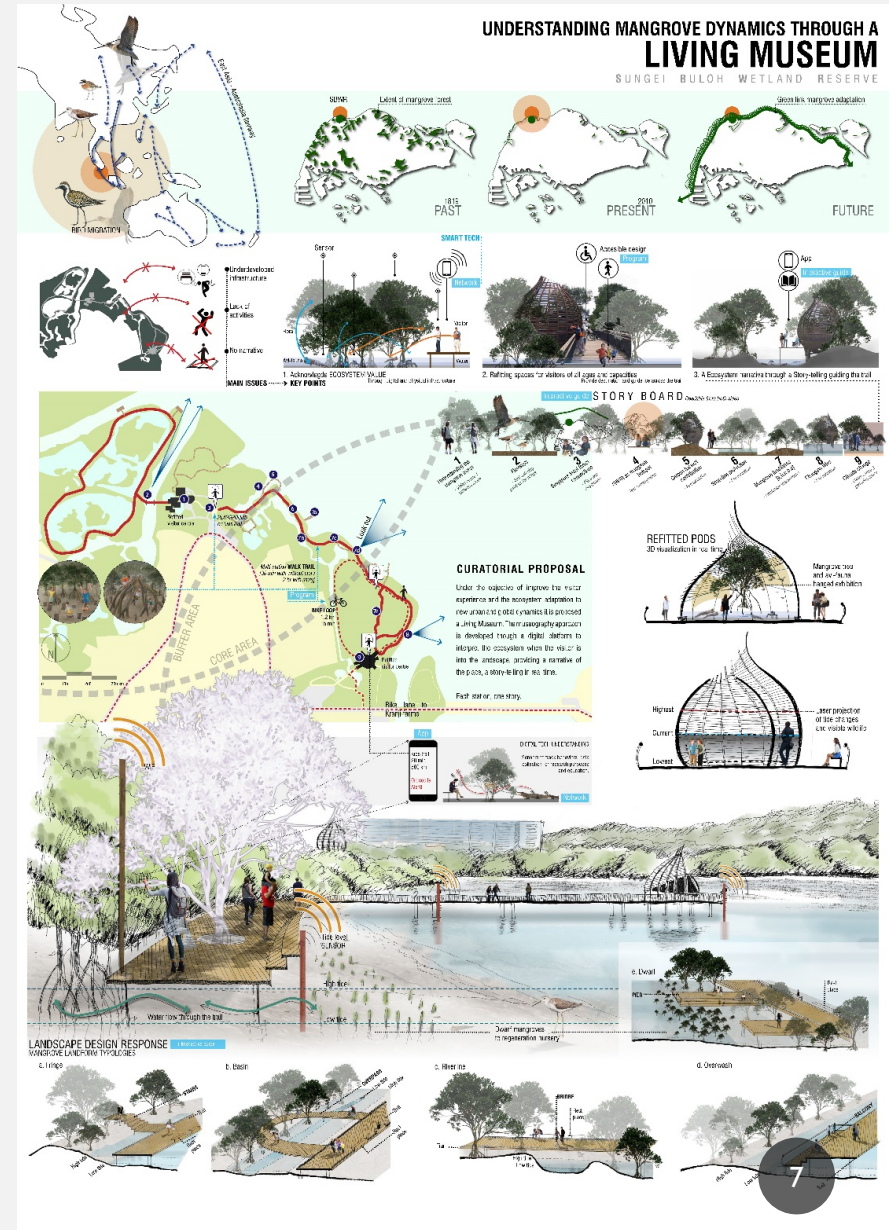



## Team members:

- Kwong Kwan Ki , *The University of Hong Kong*
- Zhu Qiang, *Beijing Forestry University, China*
- Vanessa Juan, *Temasek Polytechnic, Singapore*







# DAY 1 – 14 JUL 2018 | CHARRETTE STUDENT WELCOME PARTY

## National University of Singapore Ridgeview Residential College







## DAY 2 – 15 JUL 2018 | CHARRETTE SITE VISIT DAY

### 3 TEAMS, 3 SITES WITH 3 DESIGN CHALLENGES











## DAY 4 – 17 JUL 2018 | PRESENTATION DAY 9 TEAMS WITH 9 FANTASTIC PRESENTATIONS





# DAY 5 – 18 JUL 2018 | IFLA 2018 CONGRESS DAY I AWARDS PRESENTATION DAY

